

IDEA BOARD

Multimedia creativity goes mobile. The Bene IDEA BOARD integrates the Hoylu Suite of software with a touch screen connected to the FRAME_S Board. So innovative work isn't just mobile; it is also possible in a small space. With the sturdy FRAME_S Board on castors you can bring the multimedia work space

exactly where you need it. A camera built right into the screen makes interaction intuitive. The results of innovative presentations and brainstorming sessions are easy to save and share. A new dimension to innovative work.



OVERVIEW

1. SUITE BY HOYLU

The Co-Creation Studio is a technology package consisting of multiple hardware and software components. The centrepiece is the software developed by Hoylu, consisting of 3 applications that enable users to navigate, draw, and write on the interactive touch-surface. The digital pen technology transforms handwritten notes into digital material. The information is transmitted from the pen to the screen via Bluetooth, using a specially patented arrangement of tiny dots on the paper.

Suite Components

- Software applications
- digital pen
- Bluetooth USB dongle
- Active USB hub
- Paper starter kit

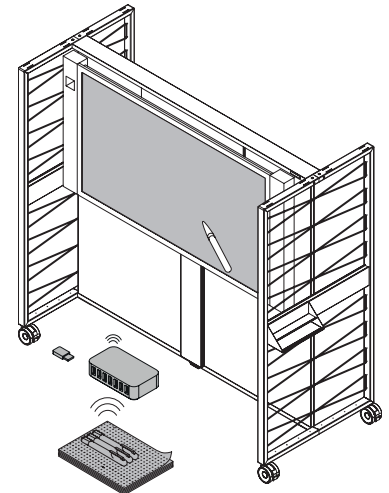

2. DISPLAY

NEC InfinityBoard (suitable for IDEA BOARD)

Large format display measuring at 65 inches with UHD resolution and InGlass™ touch technology for a smooth, paper-like touch performance. Users can write and interact creatively with both a passive stylus, as well as a finger using interactive touch. The pixel-free UHD resolution ensures a great visual experience, even from close-up.

NEC InfinityBoard components

- 65" UHD Touch Display
- OPS Slot-In PC
- Video conference camera
- High-end speaker
- Passive pen (2x)

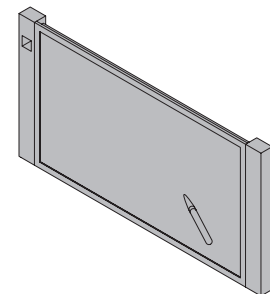

3. FRAME_S BOARD, H-TYPE

The mobile FRAME_S board on castors let you restructure open spaces in new ways.

FRAME_S Board, H-type components

- Frame
- Dividing wall
- Base set
- Cover profile
- Assembly set for CHIEF XSM1U TFT wall-mounted bracket
- CHIEF XSM1U wall-mounted bracket

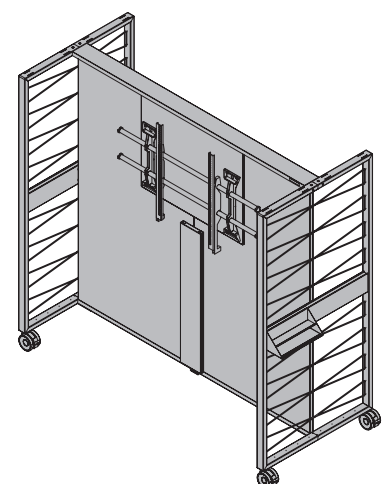

PRODUCT DESCRIPTION

1. SUITE BY HOYLU

SOFTWARE APPLICATIONS

The centrepiece is the software developed by Hoylu, consisting of 3 applications that enable users to navigate, draw, and write on the interactive touch-surface. Each Hoylu app supports multiple users and can be used either on one area or on the entire touch-surface. With Anytime Collaboration, multiple users can work in the same document from different locations and devices, both simultaneously and at different times. All data is encrypted and stored in the Microsoft Azure Cloud in Europe and can be accessed anytime and anywhere.



HOYLU FLOW

Hoylu Flow

Hoylu Flow was designed for full process planning, mind mapping and brainstorming. It allows you to design and plan your project on an intuitive and limitless screen that is ideal for collaboration. Hoylu Flow supports most of the process methods, such as Agile, BIM, LEAN, PHP, Six Sigma. In addition, common file formats such as JPG, PNG, PPT and PDF can be imported.



HOYLU SKETCH

Hoylu Sketch

Draw, paint, doodle and design everything from vivid concepts to simple notes for your team and share them with others. With Hoylu Sketch you can create content in a fast and intuitive way. There is a wide range of tools available, with which designers are also familiar with but don't require a learning phase. Hoylu Sketch has an unlimited canvas and offers the possibility to connect many different users for collaboration, regardless of their location (only with Hoylu Cloud Package).



HOYLU PAPER

Hoylu Paper

With the innovative "analog to digital" technology from Hoylu, you get the simplicity of pen and paper in your workplace. Using a Bluetooth-connected pen, you can write, draw or work together on real paper that's instantly digitised. Each stroke is recorded so that the drawings can be displayed in real time. All digital content can also be imported into Hoylu Flow and Sketch for further digital editing and enhancement.

DIGITAL PEN

An essential part of the Suite is the digital pen technology.

The pens and the associated dot grid transform handwritten notes into digital material.

There is a camera inside the pen that takes pictures at a speed of around 100 frames per second. The information is transmitted from the pen to the screen via Bluetooth, using a specially patented arrangement of tiny dots on the touch screen and paper. The pen can save up to ten pages of A4, so that the data can also be transferred subsequently from the pen to the screen.

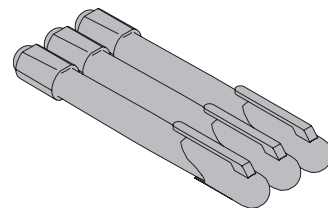

Connection: Bluetooth 2.0/4.0

Battery: Li-Polymer

Battery life: constant 5 hours, normal usage 3 days

Standby operation: 125 days

Refill: Standard D1 type (plastic/ink)

Resolution: tracking: ~1.100 dpi, pressure: 256 levels

Scanning rate: 120 Hz

Weight: 22 g

Dimensions: 156.5x11.5x11.8 mm

Internal memory: ~1.000 pages

PRODUCT DESCRIPTION

ACTIVE USB HUB

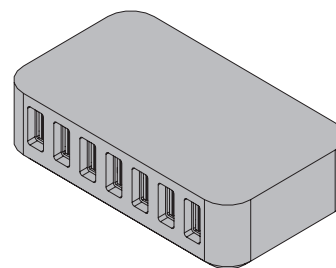

BLUETOOTH USB DONGLE

One dongle per digital pen

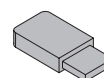

PAPER STARTER KIT

“Get Paper” – Paper with dot grid for download and printing
With the Hoylu software you can print the dot grid on normal paper using your laser printer.

Paper: Standard laser printer paper

Format: A4 or Letter format

Number of pages: 100 individual pages

Download: PDF download link available via Hoylu Paper

Print: Instructions available via Hoylu Paper

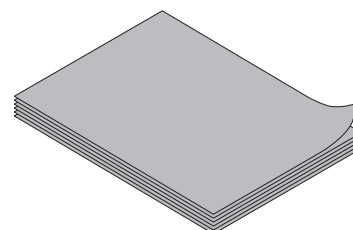

Type: Colour laser printer

Resolution: min. 600 dpi

Driver: Postscript (PS) driver

Settings:

- Print with premium quality/resolution
- Adjust page: “actual size” (no scaling! 100%)
- Disable “image optimisation settings”

PRODUCT DESCRIPTION

2. NEC INFINITYBOARD

Large format display measuring at 65 inches with UHD resolution and InGlass™ touch technology for a smooth, paper-like touch performance. Users can write and interact creatively with both a passive stylus, as well as a finger using interactive touch. The pixel-free UHD resolution ensures a great visual experience, even from close-up.



65" UHD Touch Display

Diagonal: 65" (165 cm)
Resolution: 3.840 x 2.160 at 60 Hz
Touch technology: InGlass™ touch technology
Contrast: 1300:1
Brightness: 450 (cd/m²)
Colour: Anthracite
Operating time: 24/7
VESA assembly: 4 holes; 400 mm x 400 mm (FDMI), M8
Energy efficiency class: A

Connectivity

Digital video input: 1x DisplayPort, 2 x DVI-D, 4 x HDMI
Analog audio input: 1 x 3,5 mm audio jack
Digital audio input: 1 x HDMI, DisplayPort
Input signal control:
Remote control cable (3,5 mm jack); 100 Mbit LAN, RS232
Analog audio output: 3,5 mm jack
Output signal control: 100Mbit LAN
Slot technology: OPS



OPS Slot-In PC

Processor: Intel Core i7 6700EQ 8M Cache; 4x 3,4 Ghz
Graphics: Intel® HD Graphics 530
SSD: SATA SSD (Msata) 6Gb/s (MLC), 128 GB
RAM: 8 GB

Connectivity

2 x USB 3.0, 1x Ethernet RJ45, W-LAN, 1x mini DisplayPort out
1x Audio, 1x Mic., OS: Windows 10 IoT



Video conference camera

High-resolution USB 3.0 Huddly camera
152° diagonal, 120° horizontal, 92° vertical viewing angle
16 Megapixel sensor / 720p HD 30fps output, 16:9



High-end speaker from SEAS

Maximum input power: 40 W
Nominal impedance of the speaker: 80 hm
Frequency range: 70 Hz - 15 kHz
Sound pressure level: 2,83 V



Display pen input

Passive pen (2x)
With practical ergonomics, like a pencil. 2 mm intelligent tip for a natural writing experience.

PRODUCT DESCRIPTION

3. FRAME_S BOARD, H-TYPE

- ❶ **Frame:** Metal frames consisting of two half sections.
Height 1.734,5 mm and width 860 mm
Surface: white, powder-coated
- ❷ **Dividing wall:** Width 1.821 mm
surface: Melamine, MW white
- ❸ **Base set:** Base set consists of 4 castors with locks
Surface: Plastic, white
- ❹ **Cover profile:** (with organisation profile below)
- ❺ **Assembly set for CHIEF XSM1U TFT wall-mounted bracket**
- ❻ **CHIEF XSM1U wall-mounted bracket:** maximum load
on FRAME_S Board 96 kg, on the wall 114 kg
- ❼ **Steel cup short with metal insert:** Surface WI white
- ❽ **Railing:** Material / Colour Aluminium WI white, powder-coated
- ❾ **Decorative elastic cord:** Wire hooks for attaching the cord
- ❿ **3-way connection plug board:** with 5 m starter cable

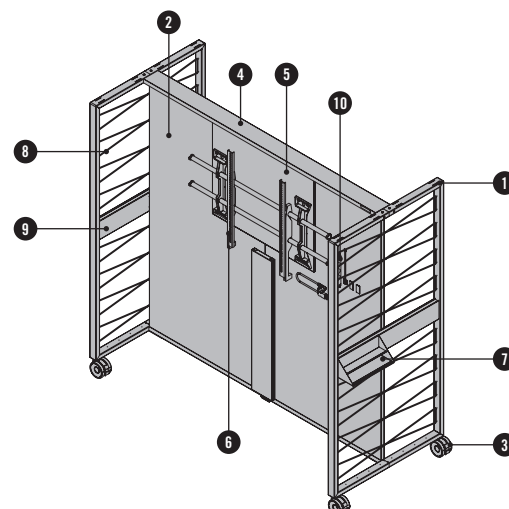

DIMENSIONS

FRAME_S BOARD, H-TYPE

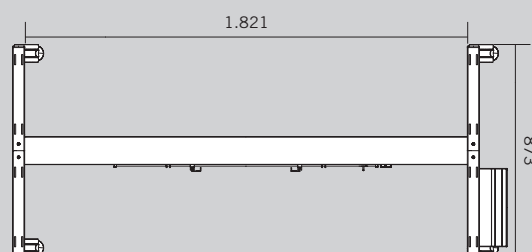
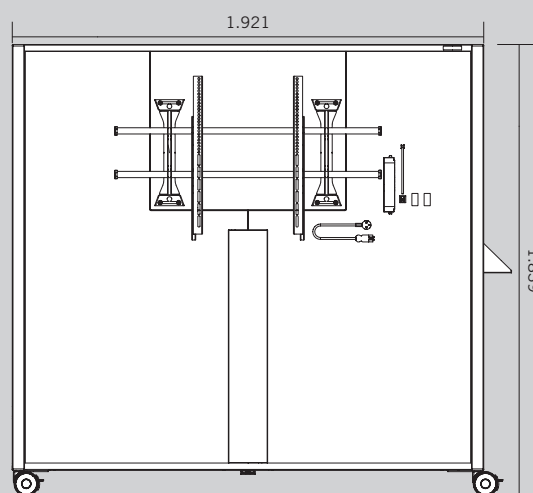

Dimensions in mm

PRODUCT DESCRIPTION

IDEA BOARD

- ① Display NEC InfinityBoard
- ② FRAME_S Board, H-Type

CABLING

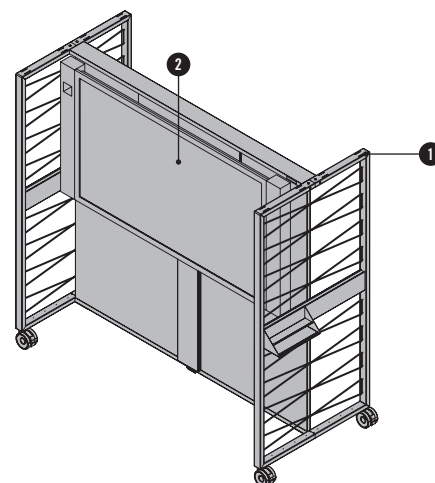
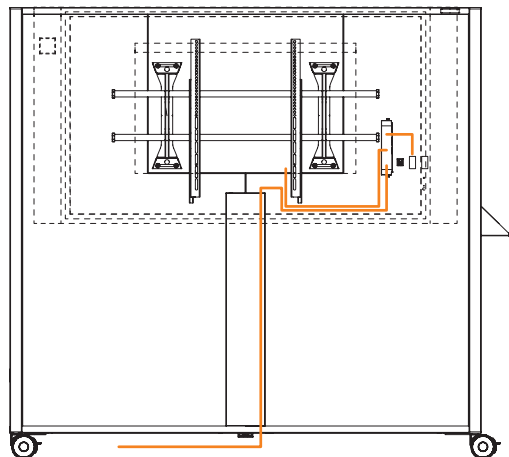

DIMENSIONS

IDEA BOARD

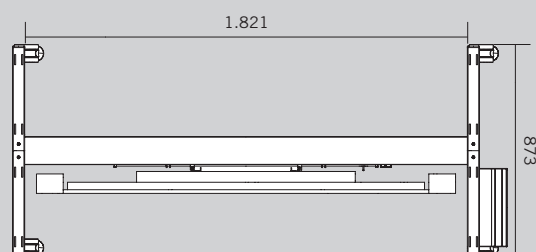
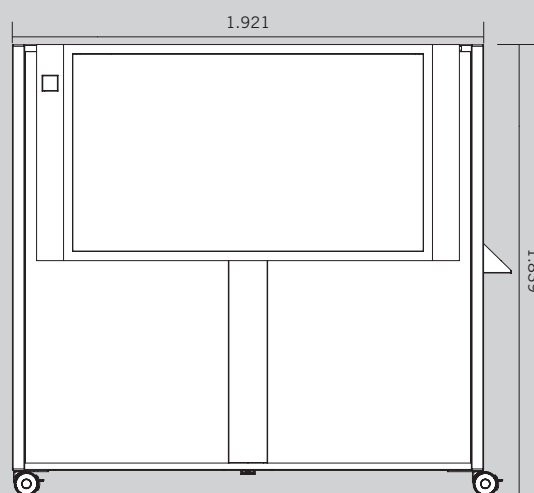

Dimensions in mm

INSPIRATIONS

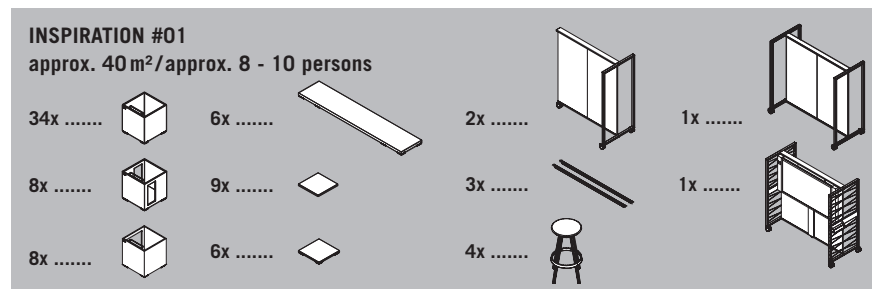

INSPIRATIONS

INSPIRATION #02

approx. 40 m²/approx. 8 - 10 persons

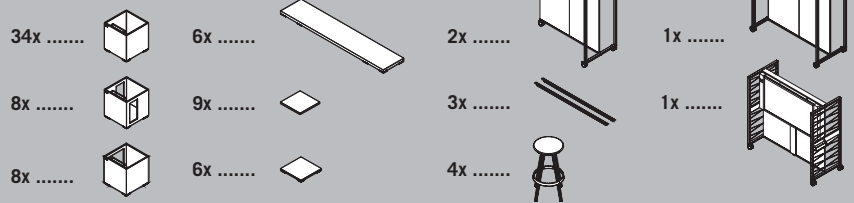

INSPIRATIONS

INSPIRATION #03

approx. 40 m²/approx. 8 - 10 persons

